

SMALL-SIZE FLOWSENSOR NDV10



General

Model NDV10 is a simple type flowsensor with high quality and low price, which are to make the product become much easier to be adopted by you. Installing the flowsensor in devices developed by you or systems will help improve their functionality such as control and monitoring of the flow.

Features

- Superior repeatability
- Low pressure drop
- Output of pulses proportional to flow-rate with the amplifier-built-in magnetic sensor which is strong against electrical noises
- Simple structure
- Free installation position
- Small and light weight

Overview

Flow-rate range	1 L/min - 10 L/min
Accuracy	Within $\pm 7\%$ (RS)
Measurable fluid	City water *1
Maximum working pressure	Up to 0.75 MPa (At fluid temperature of 20°C)
Pulse unit	1.12 mL/p (There is possibility that piping condition of the equipment in which NDV10 is installed influences and varies this pulse unit.)
Pressure drop	27 kPa at 10 L/min
Working temperature range	Fluid: 0 - +40°C Ambient: 0 - +40°C (35-85%RH, Dew condensation must be avoided)
Connection	Please refer to External Dimension
Power supply for the sensor	3 - 30 V DC (Vcc)
Transmitting wire connection	Connector-pin connection method
Output signal	Voltage pulse

	<table border="1" style="float: right; margin-left: 20px;"> <thead> <tr> <th>Vcc</th> <th>H</th> </tr> </thead> <tbody> <tr> <td>3V</td> <td>Not less than 2V</td> </tr> <tr> <td>12V</td> <td>Not less than 10V</td> </tr> <tr> <td>30V</td> <td>Not less than 27V</td> </tr> </tbody> </table> <p>Duty ratio: $2/8 < A/B < 8/2$ Note: Please utilize at electric load resistance not less than 10KΩ.</p>	Vcc	H	3V	Not less than 2V	12V	Not less than 10V	30V	Not less than 27V
	Vcc	H							
3V	Not less than 2V								
12V	Not less than 10V								
30V	Not less than 27V								
Weight	Approx. 12g								
Material of the main parts	<p>Casing ----- ABS resin containing glass fiber (Color: Milk white)</p> <p>Vane wheel -- Polyacetal resin containing carbon fiber</p> <p>Shaft ----- SUS304</p> <p>Magnet ----- Samarium cobalt magnet</p>								

*1: For liquid other than city water, Please contact us for our checking of Suitability.

External Dimension

(Units : mm)

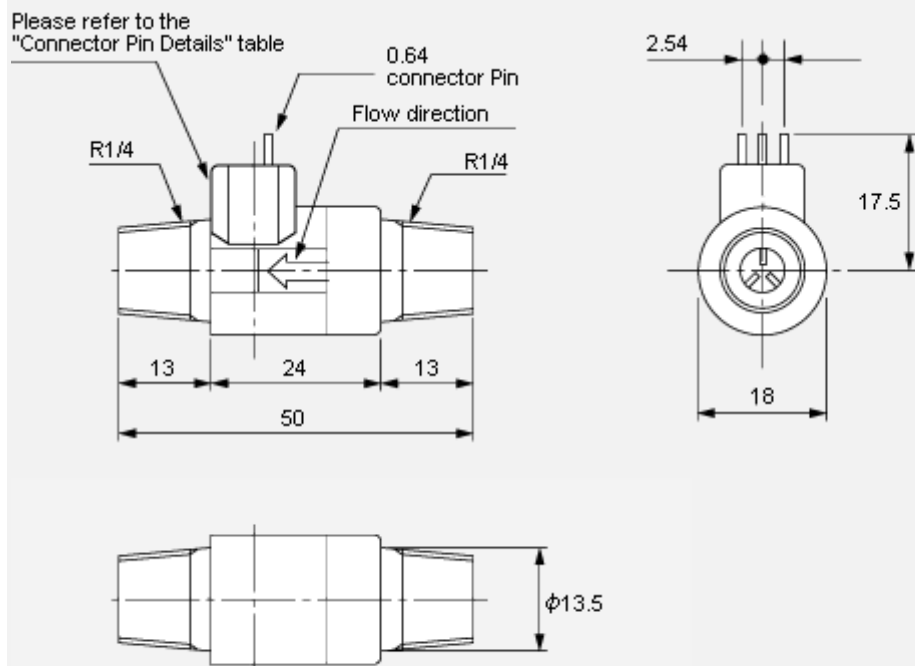

Connector Pin Details

Description on the product	Function
V+	Vcc
OUT	Vout
GND	GND